



CONCEPT WARSAW

NYX

HOTEL WARSAW  
VARSO PLACE

by Leonardo Hotels

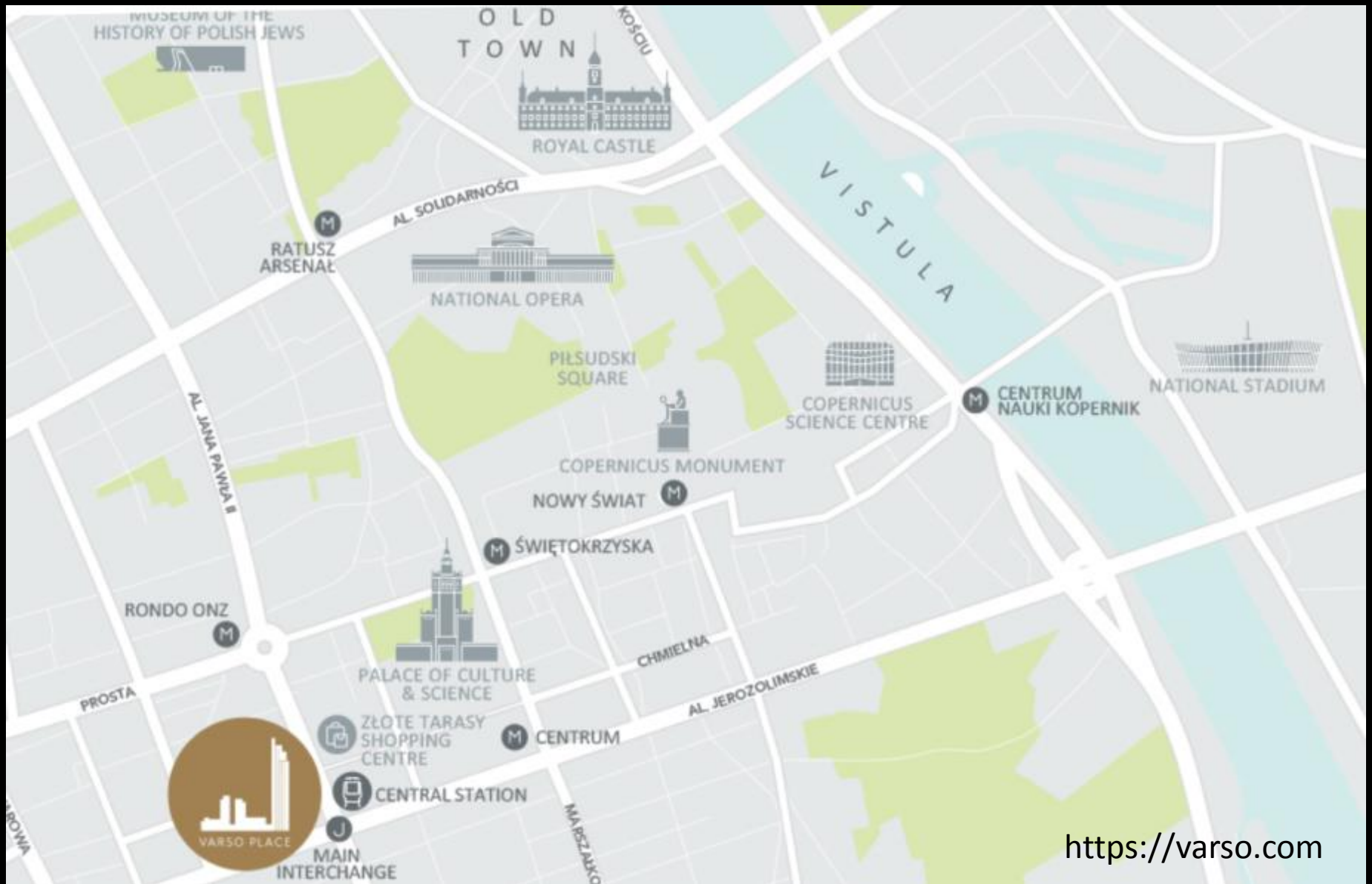

MUSEUM OF THE HISTORY OF POLISH JEWS

OLD TOWN



ROYAL CASTLE

VISTULA

AL. SOLIDARNOŚCI

RATUSZ ARSENAL



NATIONAL OPERA

PIŁSUDSKI SQUARE



COPERNICUS SCIENCE CENTRE



NATIONAL STADIUM

CENTRUM NAUKI KOPERNIK



COPERNICUS MONUMENT

NOWY ŚWIAT

AL. JANA PAWŁA I

ŚWIĘTOKRZYSKA

RONDO ONZ



PALACE OF CULTURE & SCIENCE

CHMIELNA

AL. JEROZOLIMSKIE

PROSTA

ZŁOTE TARASY SHOPPING CENTRE

CENTRUM

CENTRAL STATION



VARSO PLACE

MAIN INTERCHANGE

MAJERZAKÓW

<https://varso.com>







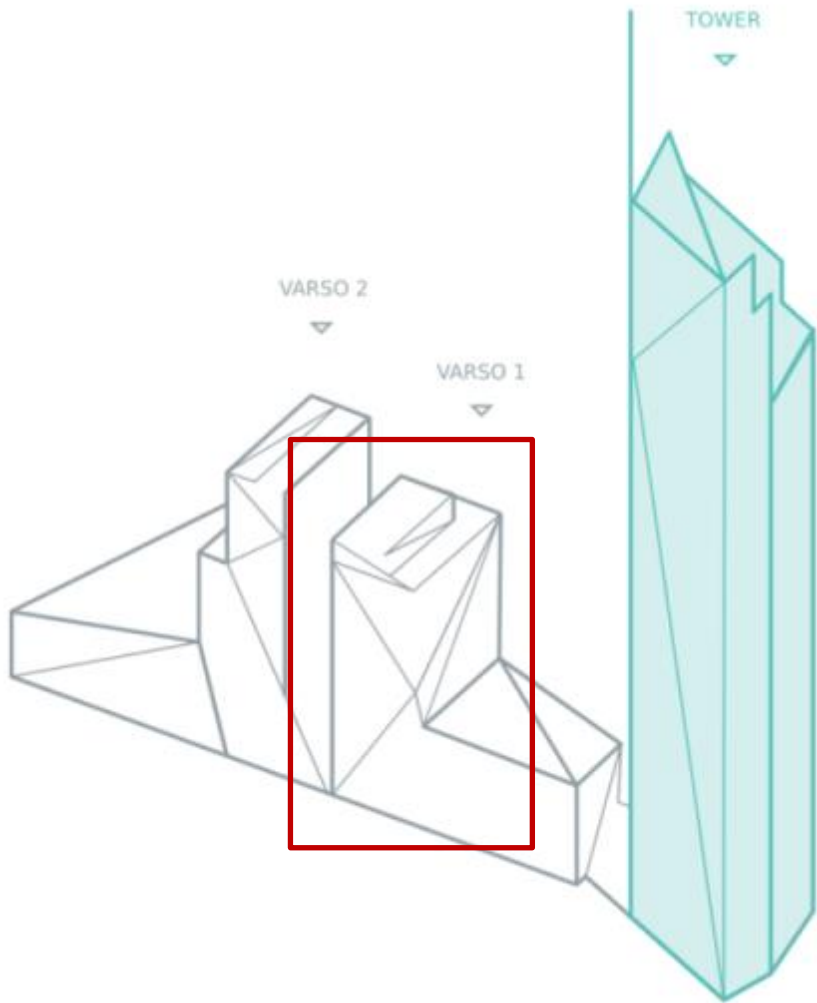

## VARSO TOWER

**310 m high**

one of the highest building in Europe

**68 755 sq m**

total project area

**2020**

delivery date



Skytop restaurant  
and bar



Breathtaking views  
over the city



14 m high  
entrance lobby

AN INTEGRAL PART  
OF THE CITY

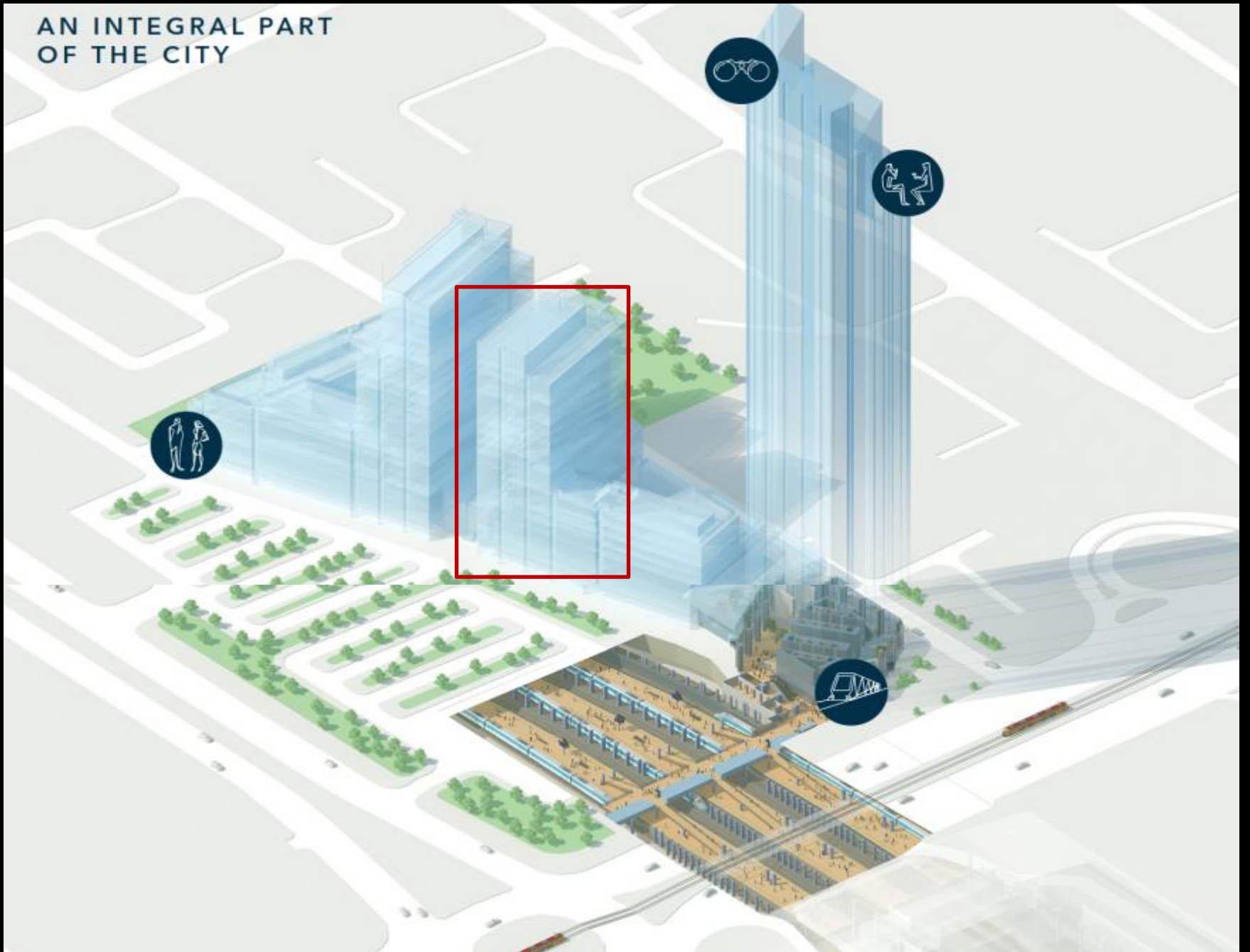



# The facts...

NYX HOTEL WARSAW

CHMIELNA STREET  
WARSAW

331 ROOMS INCL.  
35 SPACE ROOMS  
32 NYX SUITES  
2 HEAVEN SUITES

F&B

CLASH RESTAURANT  
CLASH BAR | LOBBY | LOUNGE

4 CONF. - 90/85/78/86M<sup>2</sup>

& 1 À 185M<sup>2</sup>

#LIFEATNYX

#NYXHOTELWARSAW

O 0  
P 3  
E 1  
N 2  
I 0  
N 2  
G 0

- PUBLIC PARKING



NYX

HOTEL WARSAW

by Leonardo Hotels











*clash*  
**LOBBY | BAR**

*Bar concept*

*lunch & dinner*

*"snack" concept*

# LOBBY | BAR

*Standard*

## Standard installation

- design in general Andreas Neudahm
- design light Andreas Neudahm
  - light in general – basic & LED- dimmable & possibility to set scenes Ron Baruch
- music Ron Baruch
  - speaker – „Club“ speaker - not through ELA Ron Baruch
  - Audio input for DJ Ron Baruch
  - DJ integrated in the bar
  - NO MoodMedia Music
- Instagram screens cabling & screens Ron Baruch|Bernd Westphal
- video Art screens
- Photobooth connection & machine
- W-LAN Bernd Westphal
- business | social media corner Andreas Neudahm
  - computer, Ipad Pro, printer, charger Bernd Westphal
  - Connection & cabling Ron Baruch







# LOBBY | BAR

*Standard*

## Standard installation

- fragrance
  - own NYX compilation - Black Liquid Omar Jamil | Jan Heringa
  - Diffuser at all entrances - not in the outlets Omar Jamil|Jan Heringa
- art
  - NYX Art Chairs Iris Barak
  - Sculptures
  - Walls etc.
- Puma at the entrance | lobby - fixed to the building Omar Jamil
-

# ROOMS

ALWAYS FEEL DIFFERENT, FEEL SPECIAL

adjust the room to your mood





## Categories

*Down to earth* | comfort

*Space* | deluxe room

*Nyx Suite* | Suite

*Heaven* | presidential Suite

*Standard*



# FLOORS



# FLOORS

*Standard*

## Standard installation

- Design ( wall | ceiling | floor ) & lighting in general  
Andreas Neudahm
- Music  
Ron Baruch
  - Speakers in the lift landings
- fragrance  
Omar Jamil | Jan Heringa
  - Diffuser in the lift landings
  - own NYX compilation - Black liquid  
Omar Jamil | Jan Heringa



# clash

NYX Hotel Restaurant





**RESTAURANT**

**&**

**BUFFET**

*Wooddun*

*Breakfast*

*Lunch / dinner for conferences & groups*

*no a la carte*



# RESTAURANT | BUFFET

*Standard*

## Standard installation

- design in general Andreas Neudahm
- design light Andreas Neudahm
  - light in general – basic – dimmable & possibility to set scenes Ron Baruch
  - light installation – LED – dimmable & possibility to set scenes Ron Baruch
  - separate but also connectable to other departments Ron Baruch
- Music –
  - Connection to central music – min. 2 zones Ron Baruch
- W-LAN Bernd Westphal
- Fragrance at the entrance
- art
  
- Buffet with front cooking

# MEETING & CONFERENCE

4 rooms  
90/85/78/86m<sup>2</sup> per  
room all connectable to  
one room with 339m<sup>2</sup> → 300 pax

1 room à 150 persons  
185 m<sup>2</sup>



Meeting

The image shows a detailed architectural floor plan of a building. Three specific areas are highlighted with blue borders and colored backgrounds. The largest highlighted area is orange and contains a grid of small rectangular tables, labeled 'Meeting'. To its right is a smaller, reddish-brown highlighted area with a similar table layout, labeled 'Conference'. Below these is a yellow grid-patterned area labeled 'Pré fonction'. To the left of the yellow area is a large white rectangular area labeled 'Salle exposée'. The plan also shows various other rooms, corridors, and structural elements.

Conference

Pré fonction

Salle exposée

allgemeine service verordnungs

# FITNESS

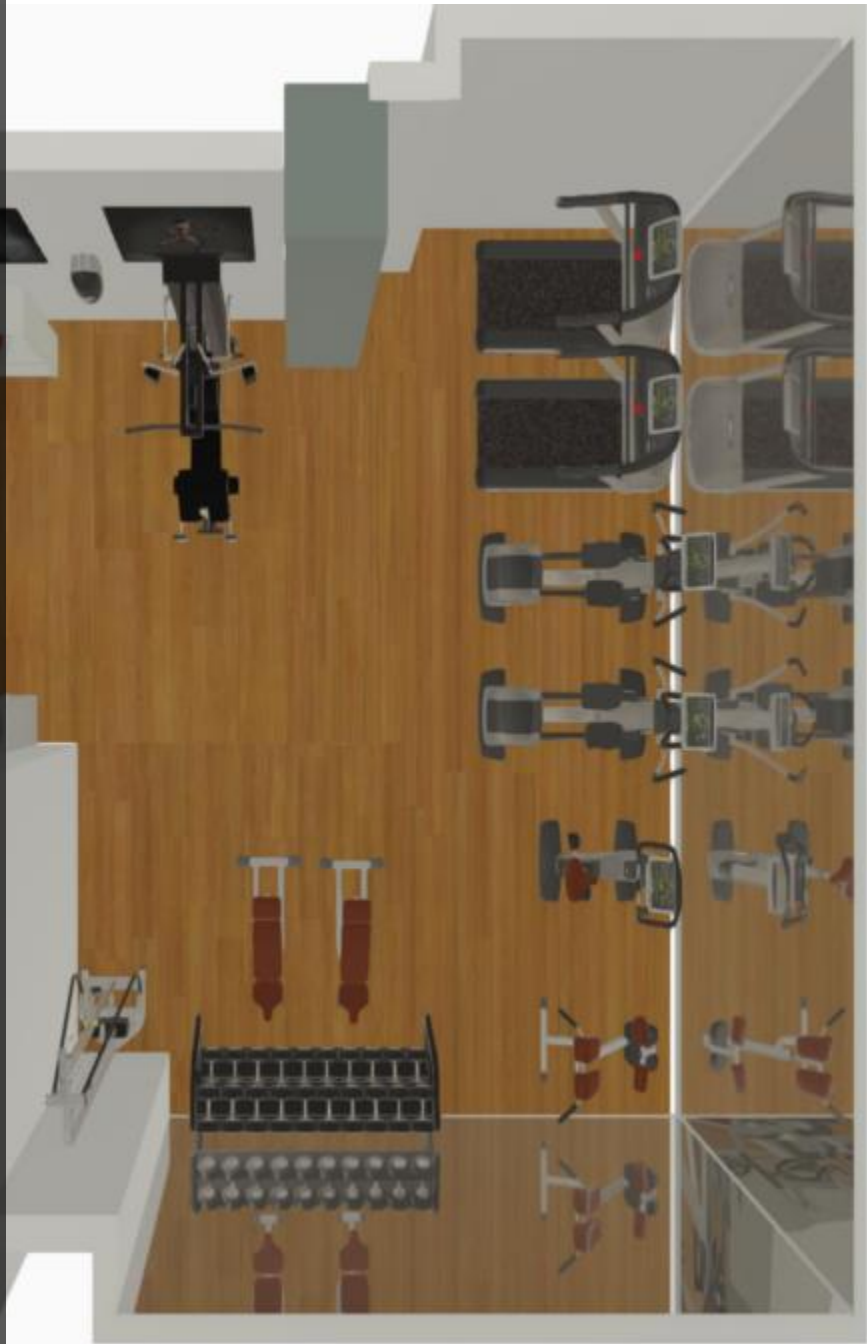

**ART**



# ART

## areas

Wallart

- tbd

Further

- Sculptures in public area

Or

- Light installation

# ROOFTOP TERRACE

on the 19th floor

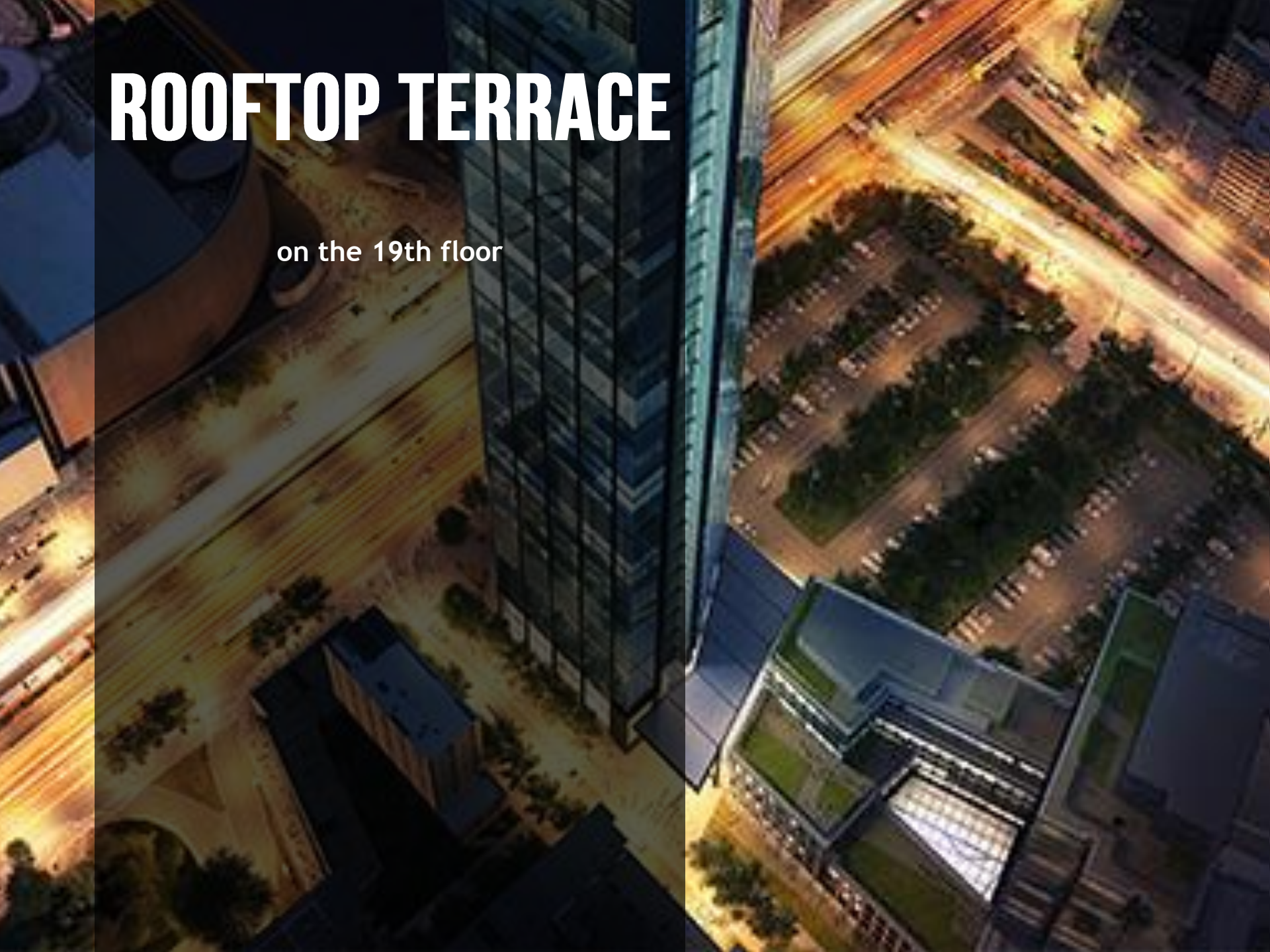



*Thank*  
**YOU**